

SERVOACTUATORS > SA 3

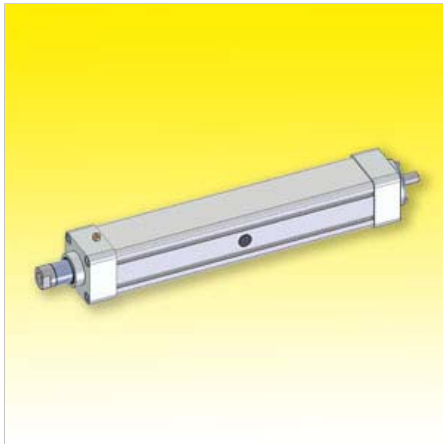

SERVOACTUATORS SA 3

Easy to fit customers servomotors

Features

Electric linear actuator, input shaft version, design to fit servomotor supplied by customer. Standard cylindrical input shaft (available upon request custom sizes, with or without key) or specific coupling for motors / gearmotors supplied by customer.

Fixing interface according to ISO 15552 standards

Squared outer profile 75 mm

Push rod diameter 30 mm

Ball screw (diameter x lead) 20 x Ph mm

Axial recirculation of the balls inside the nut

Integrated system for lubricant sealing inside the ball nut: the lubricant is only where needed.

Available upon request solutions with zero-backlash nuts or preloaded nuts, whirled ball screws with high accuracy grade (IT3 or IT5).

Discover all the advantages of Servomech solutions for ball screws and nuts with axial recirculation of the balls for **high accuracy and performances**.

Compact and robust design, lightweight technology to reach great resistance and high performances with low inertia of the components.

Construction technology:



High Dynamic Efficiency Technology



Stiffness for Motion Technology



Accuracy and Repeatability Management System



Extended Service Life Technology

Discover all the advantages of Linearmech construction technology.

Accessories and options

- Electric limit switches
- Wide choice of mounting attachments according to ISO 15552 standards

Other products you may like:

SA3 IL ("In-Line" Servoactuator with brushless servomotor)

SA 3 PD ("Parallel Design" Servoactuator with brushless servomotor)

Other products from the Series:

SA Series (0 N), **SA 0** (5500 N), **SA 1** (5500 N), **SA 2** (6400 N), **SA 3** (8590 N), **SA 4** (12180 N), **SA 5** (37000 N), **SA 6** (46300 N)